

Recommended P.C.B Layout(Top Side)
 (PCB BOARD TOLERANCE±0.05)

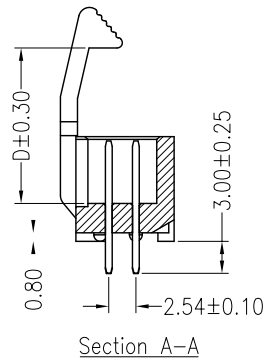
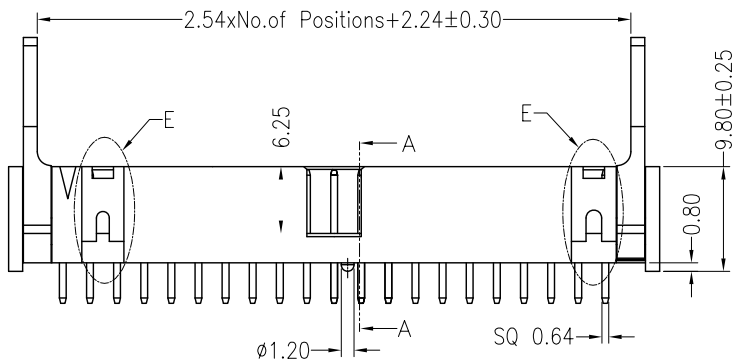
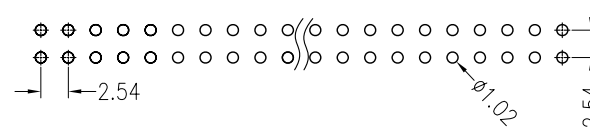

Dimension D	
050B0xx-1xxD / E: long latch	14.55
050B0xx-1xxC / E: short latch	10.65

Bestellinformation

Anzahl der Kontakte: 6,10,14,16, 20,26,30,34,40,50,60,64
 C: kurzer Hebel, quer / D: langer Hebel, quer / E: Extended / T: Hochtemperatur / Verpackung siehe Anmerkung

050B040-133C/ET

Pin Länge: 3: 3,0mm
 3: 30µ" (0,76 µm) / 4: Flash Gold
 1: Gerade
 B: Black color

Verpackung: Tray

NOTES:
 Current Rating:3.0AMP
 Voltage Rating:350V
 Contact Resistance:20mΩ max
 Withstand Voltage:1000V AC/DC
 Insulation Resistance:1000MΩ min
 Operation Temperature:-40°C to +105°C

Contact Material:Brass
 Contact plating:Au or Sn Over Ni
 Latch Material:Zinc Alloy
 Latch plating: Ni
 Insulator Material:PBT or PA6T+30%G.F UL94V-0

3	120130	Logo changed	rok
2	110802	dimension D corrected	rok
1	101018	Part No. Description added	rok
0	101008	issued	rok
REV	DATE	NOTE	NAME