

SPECIFICATIONS

Current Rating: 1.5AMP
 Contact Resistance: 20m Max.
 Insulation Resistance: 1000M Min.
 Withstanding Voltage : 500V AC/Minute
 Operation Temperature: -40°C to +105°C
 Contact Material: Phosphor bronze/Brass
 Contact plating: Au Over Ni
 Insulator Material: Polyester (UL94V-0)
 Standard: PBT+30%GF

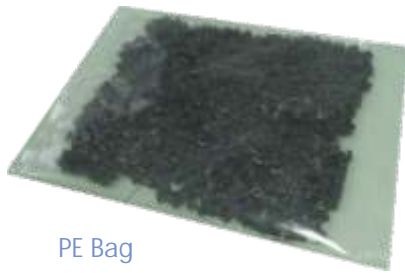

PE Bag

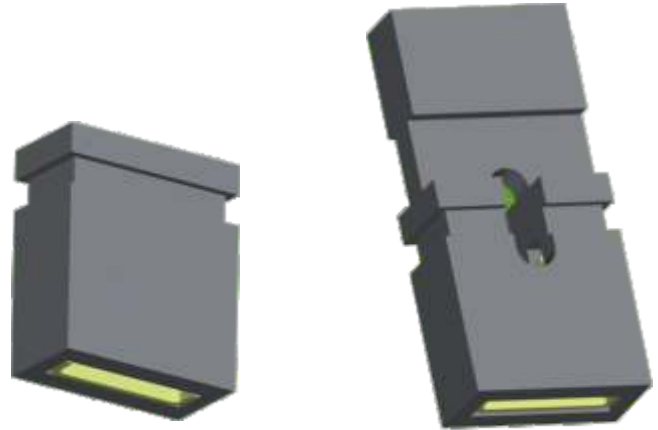

CLOSE TYPE

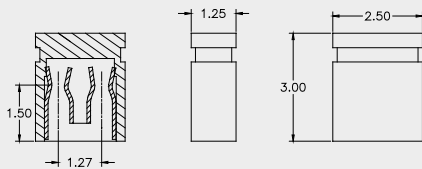

OPEN TYPE

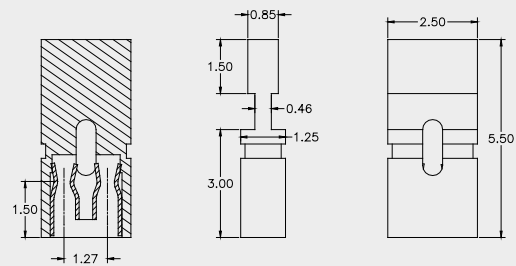

LENGTHEN

SPECIFICATIONS

Current Rating: 1.5AMP
 Contact Resistance: 20m Max.
 Insulation Resistance: 1000M Min.
 Withstanding Voltage : 500V AC/Minute
 Operation Temperature: -40°C to +105°C
 Contact Material: Phosphor bronze/Brass
 Contact plating: Au Over Ni
 Insulator Material: Polyester (UL94V-0)
 Standard: PBT+30%GF

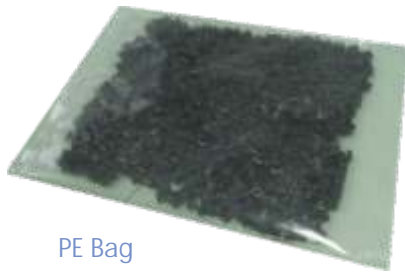

PE Bag

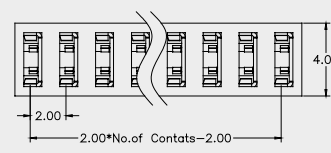
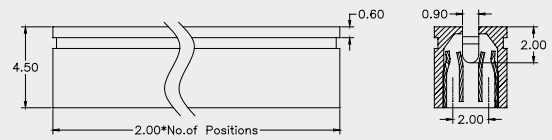
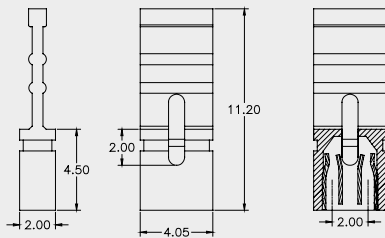
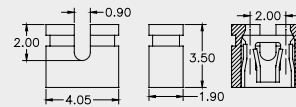
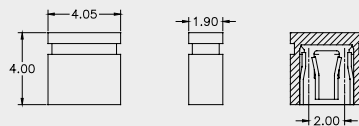

The No. of body connect is 2~9P

SPECIFICATIONS

Current Rating: 3.0AMP
 Contact Resistance: 20m Max.
 Insulation Resistance: 1000M Min.
 Withstanding Voltage : 1000V AC/Minute
 Operation Temperature: -40°C to +105°C
 Contact Material: Brass
 Contact plating: Au or Sn Over Ni
 Insulator Material: Polyester (UL94V-O)
 Standard: PBT+30%GF

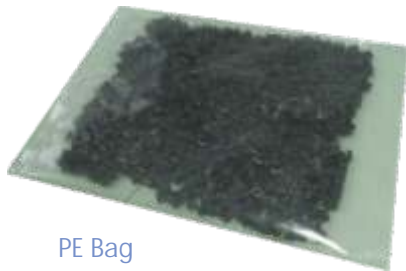

PE Bag

